

## Funkčné koncovky Functional fittings

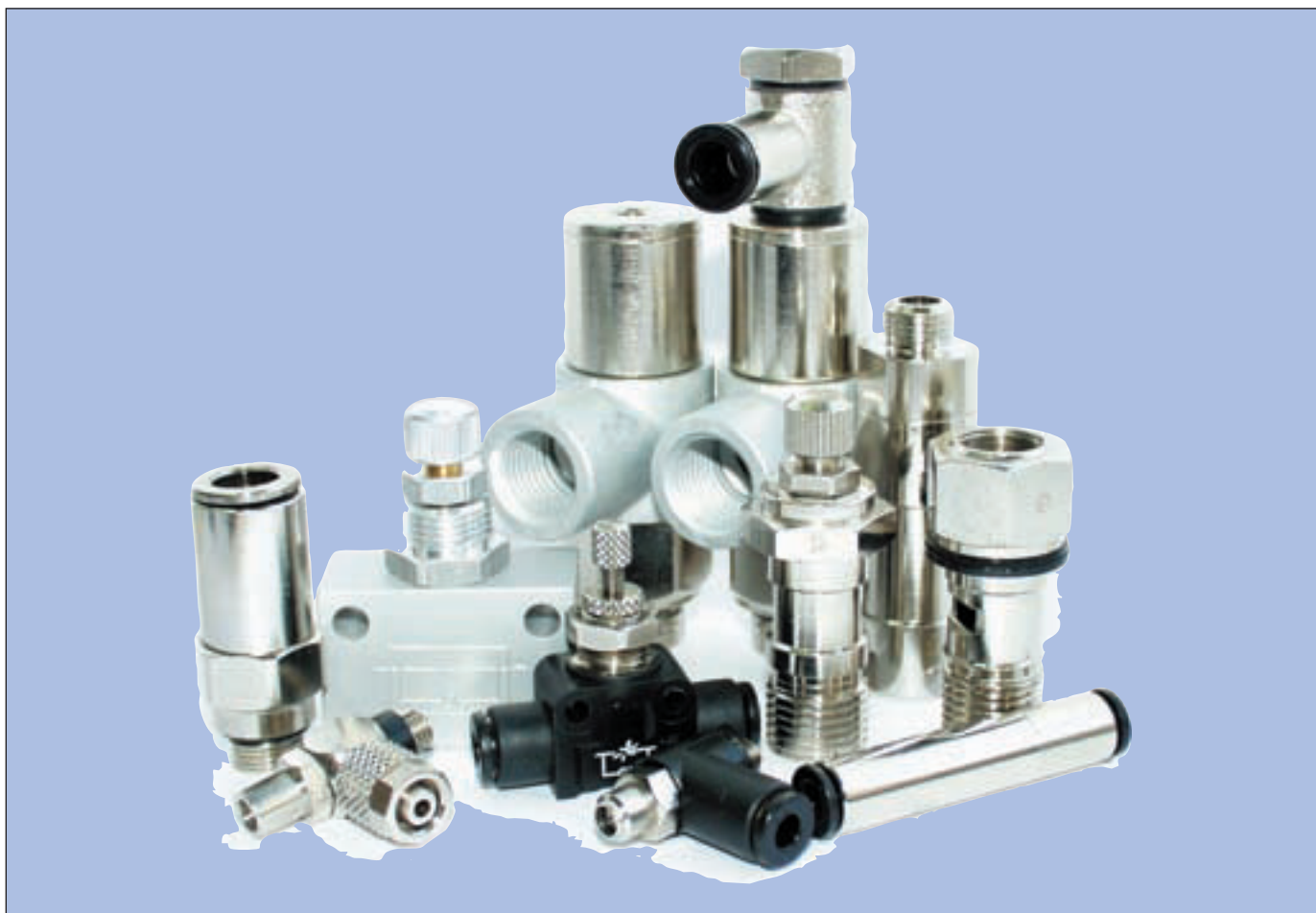

### Funkcie

- ▶ Škrtiace a spätné ventily pre rôzne pripojenia trúbky
- ▶ Mosadzné, hlinikové a plastové ventily
- ▶ Pre rôzne aplikácie
- ▶ Throttle and non-return valves with various tube connection options
- ▶ Brass, aluminium and plastic throttle valves
- ▶ For various applications

## Technické údaje **Technical data**

Pracovná teplota	-10°C až +70°C	Spätný ventil, Ventil s odfukom
	0°C až +70°C	Štandardné ventily
Pracovný tlak	max. 10bar	Tlakový regulátor - s prietokovým telom - plastový - tvarovaný blok
	0,2 až 10bar	entsperrbares Rückschlagventil, Energiesparventil, Kipphebelventil, Handschiebeventil vtso 032, 033
Materiály	0,3 až 10bar	VSR
	Teleso poniklovaná mosadz (Ms58)	Dvoj cestné regulátory tlaku, tlakový ventil, pneumatické prepínače, koncové regulátory
Závit	Plastové telo	vtso 041, 042, 043
	Hlinikové telo	Rýchloodvdušňovací ventil
Médium	O-kružok z NBR	
	Plastové tesnenie	
Závit	Plastová membrána	
	Valcový závit DIN EN ISO 228	
Médium	Kužeľ. závit DIN EN ISO 10226 (DIN 2999)	
	metr. závit ISO 261	
Médium	Mazací a nemazací stlačený vzduch	

Operating temperature	-10°C to +70°C	Non-return valve, Quick exhaust valve
	0°C to +70°C	Valves in general
Operating pressure	max. 10bar	Flow regulators - with banjo body - made of plastic - block shaped
	0,2 to 10bar	Bidirectional flow regulators, pressure control valve, pneumatic switch, slide valve vtso 032, 033
Materials	0,3 to 10bar	Quick exhaust valve
	Body, brass, nickel-plated (Ms58)	Flow regulators with banjo bodies, straight unidirectional connection, non-return valves, slide valve, quick exhaust valve Flow regulators 041, 042, 043
Threads	Body, plastics	Unidirectional flow regulator (block shaped)
	Body, aluminium	Valves in general
Medium	O-Ringe aus NBR	Valves in general
	Dichtungen aus Kunststoff	Quick exhaust valve
Medium	Membrane aus Kunststoff	
	cyl. threads DIN EN ISO 228	
Medium	con. threads DIN EN ISO 10226 (DIN 2999)	
	metr. threads ISO 261	
Medium	Lubricated and non-lubricated compressed air	

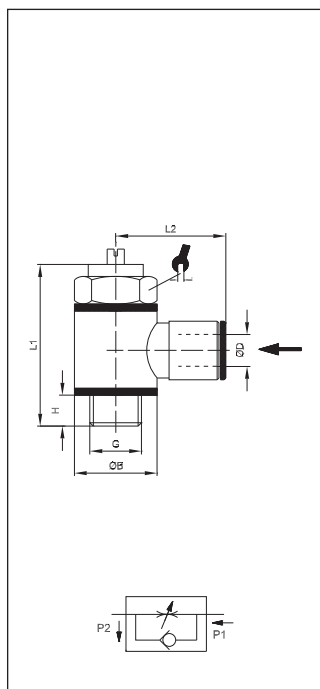

## vtso 028

**Škrtiaci ventil jednosmerný - nástrčný, škrtenie na výstupe s drážkou pre nastavenie, typ A pre ventily**

Unidirectional flow regulator type A for valves

VT	ØD	G	H	ØB	L1	L2		NI/min*	
304701	4	M5	4	SW9	25	18	8	45	50
304702	4	G <sup>1</sup> / <sub>8</sub>	5	14	32	20,5	14	310	50
304704	5	G <sup>1</sup> / <sub>8</sub>	5	14	32	22,5	14	310	50
304714	6	M5	4	SW9	25	19,5	8	45	50
304705	6	G <sup>1</sup> / <sub>8</sub>	5	14	32	23	14	390	50
304706	6	G <sup>1</sup> / <sub>4</sub>	6	18	37	24	17	710	50
304707	8	G <sup>1</sup> / <sub>8</sub>	5	14	32	24,5	14	390	25
304708	8	G <sup>1</sup> / <sub>4</sub>	6	18	37	26	17	810	25
304709	8	G <sup>3</sup> / <sub>8</sub>	6,5	21	46,5	27	20	1050	25
304710	10	G <sup>1</sup> / <sub>4</sub>	6	18	37	27	17	810	25
304711	10	G <sup>3</sup> / <sub>8</sub>	6,5	21	46,5	28	20	1050	25
304713	12	G <sup>1</sup> / <sub>4</sub>	6	18	37	28	17	810	25
304712	12	G <sup>3</sup> / <sub>8</sub>	6,5	21	46,5	29	20	1050	10

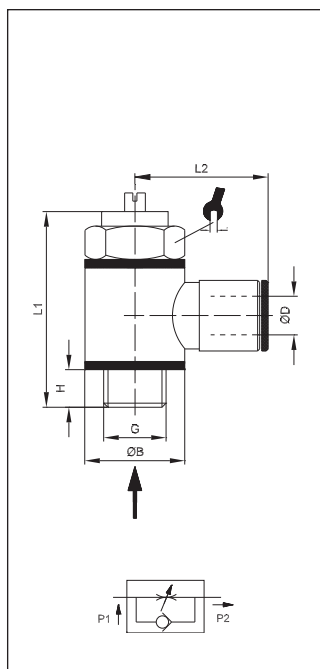

## vtso 029

**Škrtiaci ventil jednosmerný - nástrčný, škrtenie na výstupe s drážkou pre nastavenie, typ B pre valce**

Unidirectional flow regulator type B for cylinders

VT	ØD	G	H	ØB	L1	L2		NI/min*	
304801	4	M5	4	SW9	25	18	8	45	50
304802	4	G <sup>1</sup> / <sub>8</sub>	5	14	32	20,5	14	310	50
304804	5	G <sup>1</sup> / <sub>8</sub>	5	14	32	22,5	14	310	50
304814	6	M5	4	SW9	25	19,5	8	45	50
304805	6	G <sup>1</sup> / <sub>8</sub>	5	14	32	23	14	390	50
304806	6	G <sup>1</sup> / <sub>4</sub>	6	18	37	24	17	710	50
304807	8	G <sup>1</sup> / <sub>8</sub>	5	14	32	24,5	14	390	25
304808	8	G <sup>1</sup> / <sub>4</sub>	6	18	37	26	17	810	25
304809	8	G <sup>3</sup> / <sub>8</sub>	6,5	21	46,5	27	20	1050	25
304810	10	G <sup>1</sup> / <sub>4</sub>	6	18	37	27	17	810	25
304811	10	G <sup>3</sup> / <sub>8</sub>	6,5	21	46,5	28	20	1050	25
304813	12	G <sup>1</sup> / <sub>4</sub>	6	18	37	28	17	810	25
304812	12	G <sup>3</sup> / <sub>8</sub>	6,5	21	46,5	29	20	1050	10

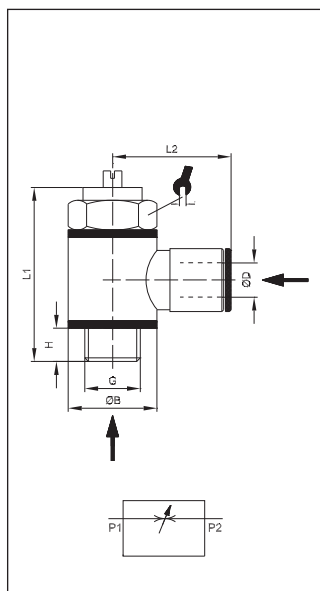

## vtso 030

**Škrtiaci ventil obojsmerný, nástrčný na jednej strane, typ C**

Bidirectional flow regulator, type C

fluid division  
**VT-HADICE & PLAST**

VT	ØD	G	H	ØB	L1	L2		NI/min*	
304901	4	M5	4	SW9	25	18	8	45	50
304902	4	G <sup>1</sup> / <sub>8</sub>	5	14	32	20,5	14	310	50
304904	5	G <sup>1</sup> / <sub>8</sub>	5	14	32	22,5	14	310	50
304914	6	M5	4	SW9	25	19,5	8	45	50
304905	6	G <sup>1</sup> / <sub>8</sub>	5	14	32	23	14	390	50
304906	6	G <sup>1</sup> / <sub>4</sub>	6	18	37	24	17	710	50
304907	8	G <sup>1</sup> / <sub>8</sub>	5	14	32	24,5	14	390	25
304908	8	G <sup>1</sup> / <sub>4</sub>	6	18	37	26	17	810	25
304909	8	G <sup>3</sup> / <sub>8</sub>	6,5	21	46,5	27	20	1050	25
304910	10	G <sup>1</sup> / <sub>4</sub>	6	18	37	27	17	810	25

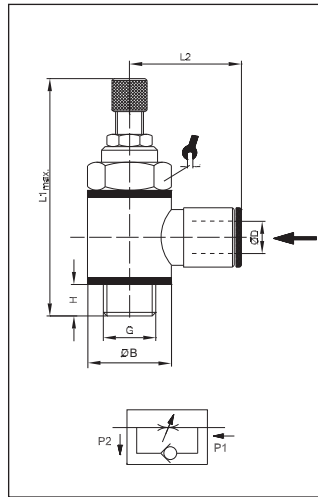

## vtso 039

### Škrtiaci ventil jednosmerný, nastrčný s kolieskom pre nastavenie, typ A pre ventily

Flow regulator with push-in fittings and handwheel regulator type A

VT	ØD	G	H	ØB	L1	L2		NI/min*	
203901	4	G <sup>1</sup> / <sub>8</sub>	5	14	49	20,5	14	310	50
203902	6	G <sup>1</sup> / <sub>8</sub>	5	14	49	23	14	390	50
203903	8	G <sup>1</sup> / <sub>8</sub>	5	14	49	24,5	14	390	50
203904	6	G <sup>1</sup> / <sub>4</sub>	6	18	56,5	24	17	710	25
203905	8	G <sup>1</sup> / <sub>4</sub>	6	18	56,5	26	17	810	25
203906	10	G <sup>1</sup> / <sub>4</sub>	6	18	56,5	27	17	810	25
203907	12	G <sup>1</sup> / <sub>4</sub>	6	18	56,5	28	17	810	25

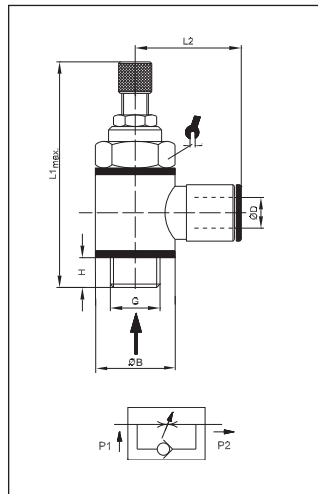

## vtso 040

### Škrtiaci ventil jednosmerný, nastrčný s kolieskom pre nastavenie, typ A pre valce

Flow regulator with push-in fittings and handwheel regulator type B

VT	ØD	G	H	ØB	L1	L2		NI/min*	
204001	4	G <sup>1</sup> / <sub>8</sub>	5	14	49	20,5	14	310	50
204002	6	G <sup>1</sup> / <sub>8</sub>	5	14	49	23	14	390	50
204003	8	G <sup>1</sup> / <sub>8</sub>	5	14	49	24,5	14	390	50
204004	6	G <sup>1</sup> / <sub>4</sub>	6	18	56,5	24	17	710	25
204005	8	G <sup>1</sup> / <sub>4</sub>	6	18	56,5	26	17	810	25
204006	10	G <sup>1</sup> / <sub>4</sub>	6	18	56,5	27	17	810	25
204007	12	G <sup>1</sup> / <sub>4</sub>	6	18	56,5	28	17	810	25

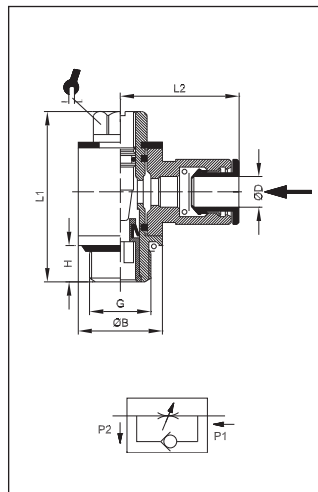

## vtso 045

### Acetal škrtiaci ventil typ A

Flow Regulator O45 Type A

VT	ØD	G	H	ØB	L1	L2		NI/min*	
204502	4	G <sup>1</sup> / <sub>8</sub>	6,5	14	32	20,5	9	310	10
204505	6	G <sup>1</sup> / <sub>8</sub>	6,5	14	32	23	9	390	10
204506	6	G <sup>1</sup> / <sub>4</sub>	8	18	37	24	12	710	10
204507	8	G <sup>1</sup> / <sub>8</sub>	6,5	14	32	24,5	9	390	10
204508	8	G <sup>1</sup> / <sub>4</sub>	8	18	37	26	12	810	10
204510	10	G <sup>1</sup> / <sub>4</sub>	8	18	37	27	12	810	10
204514	12	G <sup>1</sup> / <sub>4</sub>	8	18	37	28	12	810	10

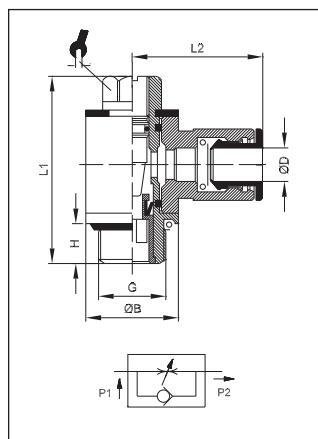

## vtso 046

### Acetal škrtiaci ventil typ B

Flow Regulator O46 Type B

VT	ØD	G	H	ØB	L1	L2		NI/min*	
204602	4	G <sup>1</sup> / <sub>8</sub>	6,5	14	32	20,5	9	310	10
204605	6	G <sup>1</sup> / <sub>8</sub>	6,5	14	32	23	9	390	10
204606	6	G <sup>1</sup> / <sub>4</sub>	8	18	37	24	12	710	10
204607	8	G <sup>1</sup> / <sub>8</sub>	6,5	14	32	24,5	9	390	10
204608	8	G <sup>1</sup> / <sub>4</sub>	8	18	37	26	12	810	10
204610	10	G <sup>1</sup> / <sub>4</sub>	8	18	37	27	12	810	10
204614	12	G <sup>1</sup> / <sub>4</sub>	8	18	37	28	12	810	10

fluid division  
VT-HADICE & PLAST

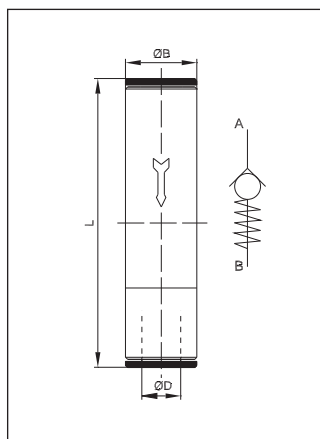

## vtso 032

### Jednosmerná priama spojka nástrčná

Straight unidirectional connection

VT	ØD	ØB	L	■
203201	4	9	44,5	50
203203	6	11	50	25
203204	8	13	53,5	25

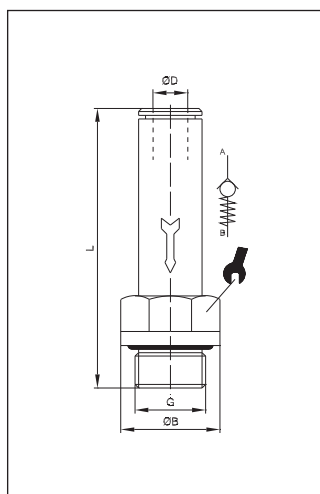

## vtso 033

### Priamý prípoj so spätným ventilom

Straight connection with non-return valve

VT	ØD	G	ØB	L	■	■
203301	4	M5	8	37	9	50
203302	4	G <sup>1</sup> / <sub>8</sub>	13	30	11	50
203307	6	G <sup>1</sup> / <sub>8</sub>	13	37,5	13	50
203308	6	G <sup>1</sup> / <sub>4</sub>	16	38	14	50
203309	8	G <sup>1</sup> / <sub>8</sub>	13	38	15	50
203310	8	G <sup>1</sup> / <sub>4</sub>	16	39	16	50
203312	10	G <sup>1</sup> / <sub>4</sub>	16	42,5	18	25
203313	10	G <sup>3</sup> / <sub>8</sub>	20	42,5	18	25
203315	12	G <sup>1</sup> / <sub>2</sub>	25	45	22	10
203317	14	G <sup>1</sup> / <sub>2</sub>	25	52,5	25	10

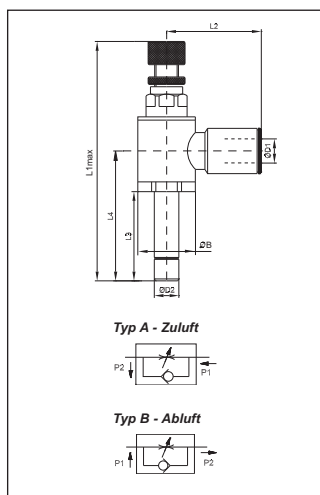

## vtso 050 / vtso 051

### Jednosmerný škrtiaci ventil typ A, typ B

Unidirectional flow regulator, pluggable

VT	ØD1	ØD2	ØB	L1	L2	L3	L4	NI/min*	■
vtso 050									
205003A	6	6	11	59,5	23	18	28	310	25
205004A	8	8	13	61	24,5	19,5	29,5	390	25
205009A	6	8	11	61	23	19,5	28	310	25

VT	ØD1	ØD2	ØB	L1	L2	L3	L4	NI/min*	■
vtso 051									
205103B	6	6	11	59,5	23	18	28	310	25
205104B	8	8	13	61	24,5	19,5	29,5	310	25
205109B	6	8	11	61	23	19,5	28	390	25

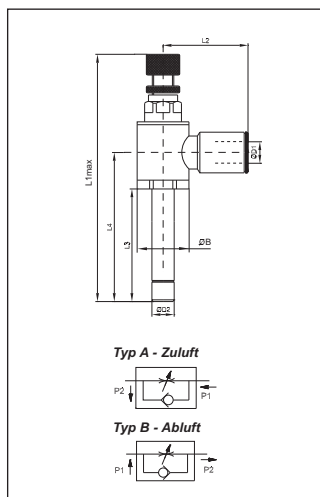

## vtso 050/L / vtso 051/L

### Jednosmerný škrtiaci ventil dlhý typ A, typ B

Unidirectional flow regulator, pluggable - long

fluid division  
VT-HADICE & PLAST

VT	ØD1	ØD2	ØB	L1	L2	L3	L4	NI/min*	■
vtso 050/L									
205003-2A	6	6	11	102	23	60	70	310	25
205004-1A	8	8	13	103	24,5	61,5	71,5	390	25
205009-1A	6	8	11	103	23	61,5	70	310	25

VT	ØD1	ØD2	ØB	L1	L2	L3	L4	NI/min*	■
vtso 051/L									
205103-2B	6	6	11	102	23	60	70	310	25
205104-1B	8	8	13	103	24,5	61,5	71,5	310	25

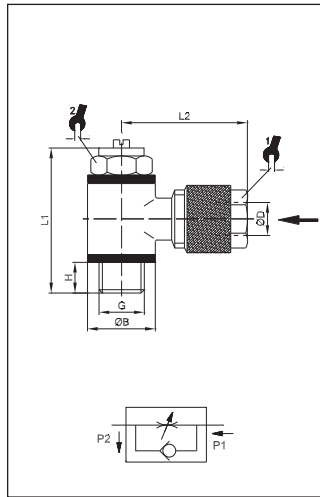

### Jednosmerný škrtiaci ventil typ A pre ventily

Unidirectional flow regulator, type A for valves

VT	ØD	G	H	ØB	L1	L2			NI/min*	
304105	5/3	M5	4	SW9	25	16	8	8	45	50
304100	5/3	G <sup>1/8</sup>	5	14	32	21	8	14	310	50
304106	6/4	M5	4	SW9	25	16	9	8	45	50
304101	6/4	G <sup>1/8</sup>	5	14	32	21,5	10	14	310	50
304102	6/4	G <sup>1/4</sup>	6	18	37	24,5	10	17	420	50
304103	8/6	G <sup>1/8</sup>	5	14	32	20,5	12	14	310	50
304104	8/6	G <sup>1/4</sup>	6	18	37	22,5	12	17	420	50

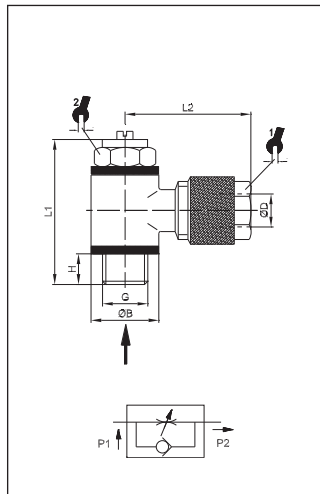

### Jednosmerný škrtiaci ventil typ B pre valce

Unidirectional flow regulator, type B for cylinders

VT	ØD	G	H	ØB	L1	L2			NI/min*	
304205	5/3	M5	4	SW9	25	16	8	8	45	50
304200	5/3	G <sup>1/8</sup>	5	14	32	21	8	14	310	50
304206	6/4	M5	4	SW9	25	16	9	8	45	50
304201	6/4	G <sup>1/8</sup>	5	14	32	21,5	10	14	310	50
304202	6/4	G <sup>1/4</sup>	6	18	37	24,5	10	17	420	50
304203	8/6	G <sup>1/8</sup>	5	14	32	20,5	12	14	310	50
304204	8/6	G <sup>1/4</sup>	6	18	37	22,5	12	17	420	50
304207	8/6	G <sup>3/8</sup>	6	21,5	46	24,5	12	20	500	50

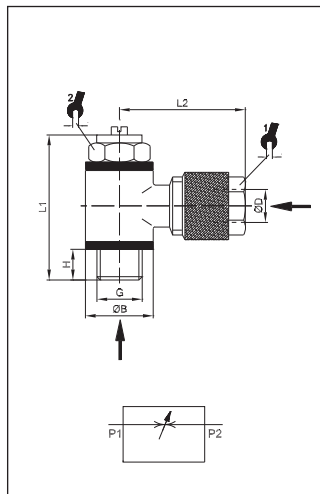

### Obojstranný škrtiaci ventil, typ C

Bidirectional flow regulator, type C

VT	ØD	G	H	ØB	L1	L2			NI/min*	
304305	5/3	M5	4	SW9	25	16	8	8	45	50
304306	6/4	M5	4	SW9	25	16	9	8	45	50
304301	6/4	G <sup>1/8</sup>	5	14	32	21,5	10	14	310	50
304302	6/4	G <sup>1/4</sup>	6	18	37	24,5	10	17	420	50
304303	8/6	G <sup>1/8</sup>	5	14	32	20,5	12	14	310	50
304304	8/6	G <sup>1/4</sup>	6	18	37	22,5	12	17	420	50

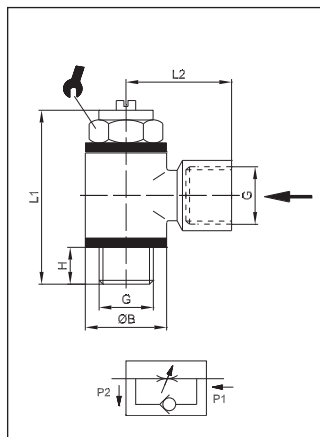

### Jednosmerný škrtiaci ventil typ A, vnútorný závit

Unidirectional flow regulator type A, for valves (female thread)

VT	G	H	ØB	L1	L2		NI/min*	
304401	M5	4	SW9	25	11,5	8	45	50
304402	G <sup>1/8</sup>	5	14	32	21	14	310	50
304403	G <sup>1/4</sup>	6	18	37	25,5	17	450	50
304404	G <sup>3/8</sup>	7	21	46	26	20	1040	25
304405	G <sup>1/2</sup>	10	26	52,5	32	26	2200	10

fluid division  
VT-HADICE & PLAST

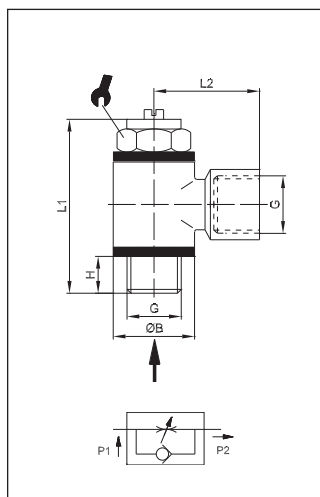

### Jednosmerný škrtiaci ventil typ B pre valce, vnútorný závit

Unidirectional flow regulator type B, for cylinders (female thread)

VT	G	H	ØB	L1	L2		NI/min*	
304501	M5	4	SW9	25	11,5	8	45	50
304502	G <sup>1</sup> / <sub>8</sub>	5	14	32	21	14	310	50
304503	G <sup>1</sup> / <sub>4</sub>	6	18	37	25,5	17	450	50
304504	G <sup>3</sup> / <sub>8</sub>	7	21	46	26	20	1040	25
304505	G <sup>1</sup> / <sub>2</sub>	10	26	52,5	32	26	2200	10

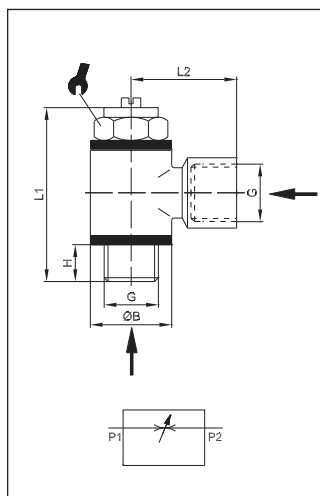

### Obojstranný škrtiaci ventil typ C, vnútorný závit

Bidirectional flow regulator type C (female thread)

VT	G	H	ØB	L1	L2		NI/min*	
304601	M5	4	SW9	25	11,5	8	45	50
304602	G <sup>1</sup> / <sub>8</sub>	5	14	32	21	14	310	50
304603	G <sup>1</sup> / <sub>4</sub>	6	18	37	25,5	17	450	50
304604	G <sup>3</sup> / <sub>8</sub>	7	21	46	26	20	1040	25
304605	G <sup>1</sup> / <sub>2</sub>	10	26	52,5	32	26	2200	10

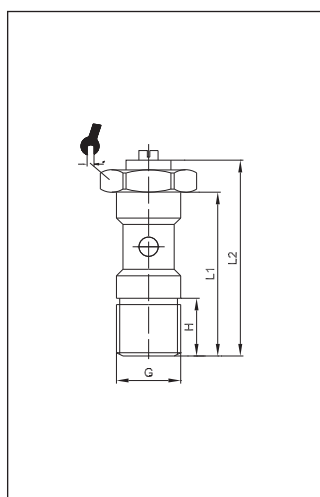

### Ventil pre škrtiaci ventil s dražkovou hlavou

Screw for flow regulation with slotted screw

A=Pre ventily A=for valves  
B=Pre valce B=for cylinders  
C=Obojstranné C=bidirectional

VT	Typ	G	H	L1	L2		NI/min*	
304000	B	M5	4,5	16,5	25	8	45	50
304001	A	G <sup>1</sup> / <sub>8</sub>	9,5	23,5	32	14	310	50
304002	A	G <sup>1</sup> / <sub>4</sub>	11	28	37	17	810	50
304003	B	G <sup>1</sup> / <sub>8</sub>	9,5	23,5	32	14	310	50
304004	B	G <sup>1</sup> / <sub>4</sub>	11	28	37	17	810	50
304005	C	G <sup>1</sup> / <sub>8</sub>	9,5	23,5	32	14	310	50
304006	C	G <sup>1</sup> / <sub>4</sub>	11	28	37	17	810	50
304008	B	G <sup>3</sup> / <sub>8</sub>	14	29,8	46	19	1040	50
304009-1	A	G <sup>1</sup> / <sub>2</sub>	12,5	39	52,5	26	2200	50
304010	B	G <sup>1</sup> / <sub>2</sub>	12,5	39	52,5	26	2200	50

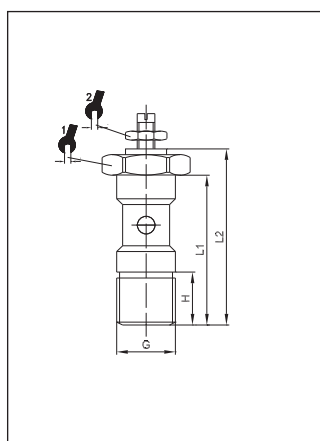

### Ventil pre škrtiaci ventil s maticou adražkovou hlavou

Screw for flow regulation with nut and slotted screw

fluid division  
VT-HADICE & PLAST

A=pre ventily A=for valves  
B=pre valce B=for cylinders  
C=obojstranné C=bidirectional

VT	Typ	G	H	L1	L2			NI/min*	
304011	A	G <sup>1</sup> / <sub>8</sub>	6,5	25,5	32,5	14	9	310	50
304012	A	G <sup>1</sup> / <sub>4</sub>	8	28	35	17	9	810	50
304013	B	G <sup>1</sup> / <sub>8</sub>	6,5	25,5	32,5	14	9	310	50
304014	B	G <sup>1</sup> / <sub>4</sub>	8	28	35	17	9	810	50
304015	C	G <sup>1</sup> / <sub>8</sub>	8	25,5	32,5	14	9	310	50
304016	C	G <sup>1</sup> / <sub>4</sub>	12	28	35	17	9	810	50

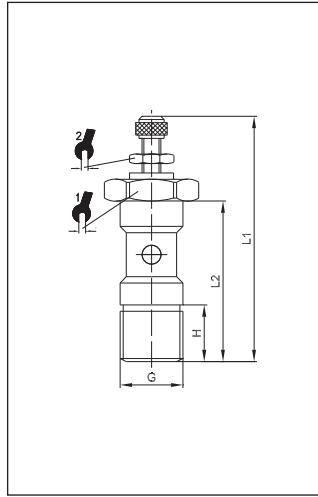

### Ventil pre škrtiaci ventil s maticou a regulačnou maticou

Screw for flow regulation with nut and regulating spindle

A=pre ventily A=for valves  
B=pre valce B=for cylinders  
C=obojsmerné C=bidirectional

VT	Typ	G	H	L1	L2	⌀	⌀	NI/min*	■
304021	A	G <sup>1</sup> / <sub>8</sub>	7	32	23,5	14	9	310	50
304022	A	G <sup>1</sup> / <sub>4</sub>	9	37	27	17	11	810	50
304023	B	G <sup>1</sup> / <sub>8</sub>	7	32	23,5	14	9	310	50
304024	B	G <sup>1</sup> / <sub>4</sub>	9	37	27	17	11	810	50
304025	C	G <sup>1</sup> / <sub>8</sub>	7	32	23,5	14	9	310	50
304026	C	G <sup>1</sup> / <sub>4</sub>	9	37	27	17	11	810	50

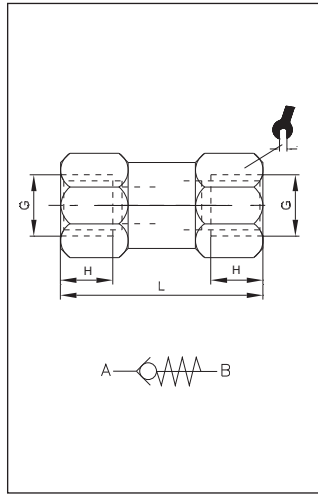

### Mosadzný spätný ventil

Non-return valve, brass nickel-plated, with hexagon

VT	G	H	L	⌀	NI/min*	■
304051	M5	5,5	26,5	8	190	50
304052	G <sup>1</sup> / <sub>8</sub>	8,5	36,5	13	920	50
304053	G <sup>1</sup> / <sub>4</sub>	9	42,5	16	1600	25
304054	G <sup>3</sup> / <sub>8</sub>	12	51	20	2430	10
304055	G <sup>1</sup> / <sub>2</sub>	14	62	24	3500	10

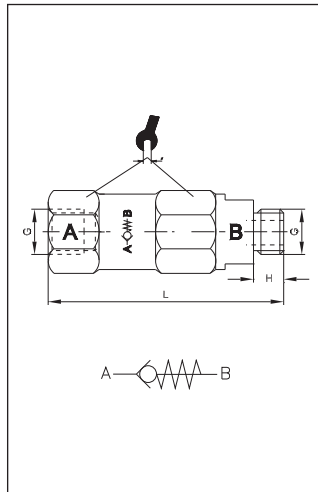

### Spätný ventil

Non-return valve

VT	G	H	L	⌀	NI/min*	■
305101	G <sup>1</sup> / <sub>8</sub>	6	53	14	920	1
305103	G <sup>1</sup> / <sub>4</sub>	9	66	19	1600	1
305105	G <sup>1</sup> / <sub>2</sub>	12	81	27	3500	1

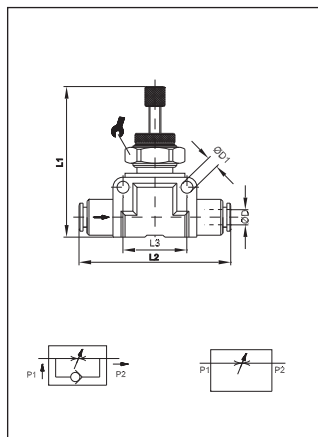

### Acetal škrtiaci ventil 041 plastový

Acetal Line Flow Regulator O41

fluid division  
VT-HADICE & PLAST

VT	ØD	ØD1	L1	L2	L3	⌀	NI/min*	■
340404	4	3,2	35	35	12	11	140	10
340606	6	3,2	45	45	15	14	260	10
340808	8	3,2	45	46	15	14	330	5
obojsmerný / bidirectional throttling								
340414	4	3,2	34	35	12	11	140	10
340616	6	3,2	45	45	15	14	260	10
340818	8	3,2	45	46	15	14	360	5



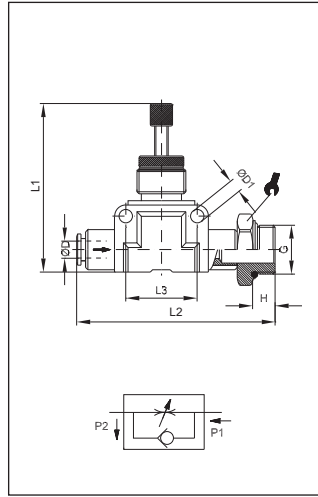

### Acetal škrtiaci ventil O42 plastový

Acetal Line Flow Regulator O42

pre ventily  
pre valce

VT	ØD	ØD1	G	H	L1	L2	L3		NI/min*	
350400	4	3,2	M5	4	35	43	12	9	110	10
350401	4	3,2	G <sup>1</sup> / <sub>8</sub>	5	35	43	12	13	140	10
350402	6	3,2	G <sup>1</sup> / <sub>8</sub>	5	45	52	15	13	260	10
350403	6	3,2	G <sup>1</sup> / <sub>4</sub>	6,5	45	54	15	16	260	10
350404	8	3,2	G <sup>1</sup> / <sub>8</sub>	5	46	53	15	14	340	10
350405	8	3,2	G <sup>1</sup> / <sub>4</sub>	6,5	46	55	15	16	340	10

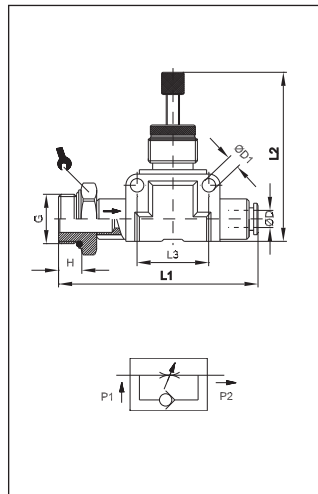

### Acetal škrtiaci ventil O43 plastový

Acetal Line Flow Regulator O43

pre ventily  
pre valce

VT	ØD	ØD1	G	H	L1	L2	L3		NI/min*	
360400	4	3,2	M5	4	35	43	12	9	110	10
360401	4	3,2	G <sup>1</sup> / <sub>8</sub>	5	35	43	12	13	140	10
360402	6	3,2	G <sup>1</sup> / <sub>8</sub>	5	45	52	15	13	260	10
360403	6	3,2	G <sup>1</sup> / <sub>4</sub>	6,5	45	54	15	16	260	10
360404	8	3,2	G <sup>1</sup> / <sub>8</sub>	5	46	53	15	14	340	10
360405	8	3,2	G <sup>1</sup> / <sub>4</sub>	6,5	46	55	15	16	340	10

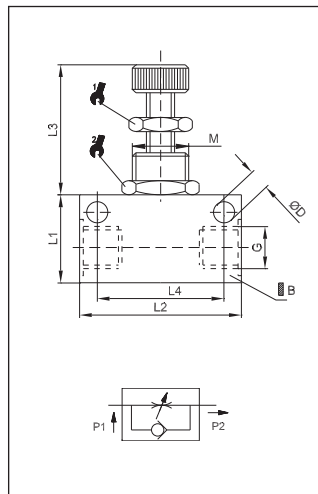

### Jednosmerný škrtiaci ventil

Unidirectional flow regulator

VT	G	L1	L2	L3	L4	ØD	B	M			NI/min*	
304030	M5	15	25	22-28	18	4,5	12	M10	12	12	250	10
304031	G <sup>1</sup> / <sub>8</sub>	21	34	27-34	25	4,5	16	M12	Ø9,5	15	450	10
304032	G <sup>1</sup> / <sub>4</sub>	30	50	36-34	35	6,5	25	M12	Ø9,5	15	600	5
304033	G <sup>3</sup> / <sub>8</sub>	30	50	35-43	35	6,5	25	M18	Ø12	22	1100	5
304034	G <sup>1</sup> / <sub>2</sub>	40	65	40-53	44	6,5	30	M22	14	26	1400	1

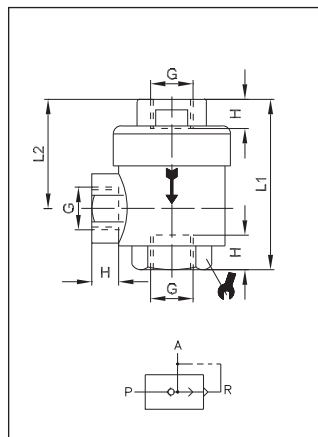

### Rychloodvzdušnovací ventil

Quick exhaust valve

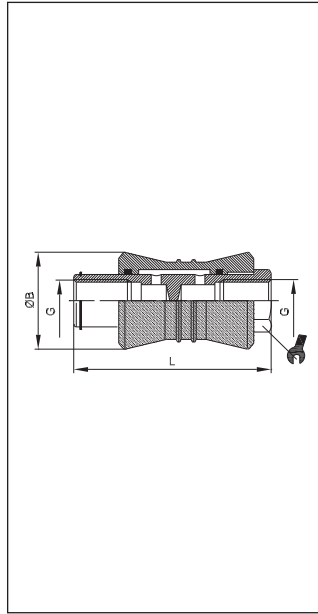

fluid division  
**VT-HADICE & PLAST**

VT	G	H	L1	L2		P-A NI/min*	A-R NI/min*	
60500	M5	5	25	17	10	220	300	25
60501	G <sup>1</sup> / <sub>8</sub>	6,5	42	27	15	680	1100	25
60502	G <sup>1</sup> / <sub>4</sub>	9,5	53	35	19	1200	2100	25
60504	G <sup>3</sup> / <sub>8</sub>	10	61	38	22	2300	4900	10
60503	G <sup>1</sup> / <sub>2</sub>	13	72	43	26	3400	6100	10
60505	G <sup>3</sup> / <sub>4</sub>	18	88	55	32	3200	8750	5
60506	G1	18	94	57,5	38	2900	10750	1



### Presuvný (uzatvarací) ventil

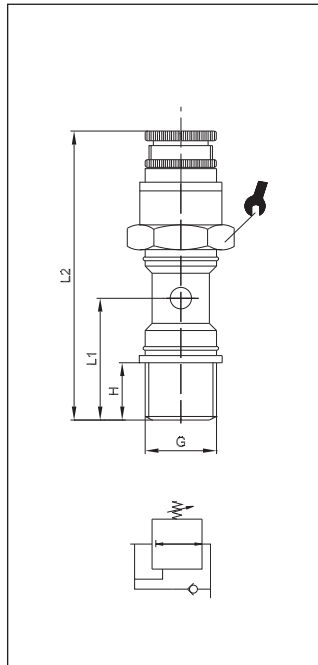

Slide valve

VT	G	ØB	L		P-A NI/min*	A-R NI/min*	
60602	G <sup>1/8</sup>	25	48	14	700	1280	10
60603	G <sup>1/4</sup>	30	58	19	1500	2220	5
60604	G <sup>3/8</sup>	35	68	22	2200	3200	5
60605	G <sup>1/2</sup>	40	80	27	3400	7500	1



### Tlakový ventil

Pressure control valve

VT	G	H	L1	L2		NI/min*	
304632	G <sup>1/8</sup>	6	15,5	56	15	580	10
304633	G <sup>1/4</sup>	8	18,5	63	17	750	10

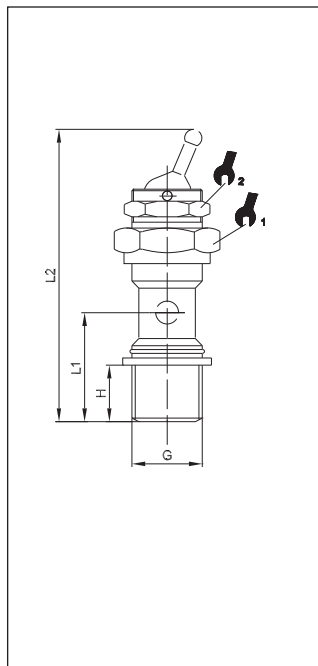



### Pneumatický prepínač

Pneumatic switch

#### 2-cestný / 2-ways-valve



fluid division  
VT-HADICE & PLAST



VT	G	H	L1	L2			NI/min*	
304173	G <sup>1/8</sup>	6	16	55	14	15	580	10
304174	G <sup>1/4</sup>	8	19	60	17	15	750	10

#### 3-cestný / 3-ways-valve



VT	G	H	L1	L2			NI/min*	
304073	G <sup>1/8</sup>	6	16	55	14	15	580	10
304074	G <sup>1/4</sup>	8	19	60	17	15	750	10

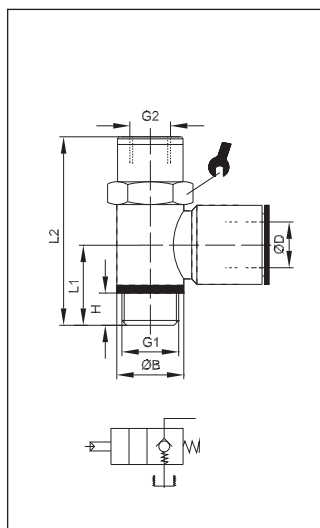

## vtso 048

### Obojstranný škrtiaci ventil

Bidirectional flow regulator

VT	ØD	G1	ØB	G2	H	L1	L2		
204802	4	G <sup>1</sup> / <sub>8</sub>	14	M5	6	15,5	42	13	10
204805	6	G <sup>1</sup> / <sub>8</sub>	14	M5	6	15,5	42	13	10
204806	6	G <sup>1</sup> / <sub>4</sub>	18	M5	8	18,5	47	17	10
204807	8	G <sup>1</sup> / <sub>4</sub>	14	M5	6	15,5	42	13	10
204808	8	G <sup>1</sup> / <sub>4</sub>	18	M5	8	18,5	47	17	10
204809	8	G <sup>3</sup> / <sub>8</sub>	21	G <sup>1</sup> / <sub>8</sub>	9	21	53,5	20	10
204810	10	G <sup>1</sup> / <sub>4</sub>	18	M5	8	18,5	47	17	10
204811	10	G <sup>3</sup> / <sub>8</sub>	21	G <sup>1</sup> / <sub>8</sub>	9	21	53,5	20	10
204814	12	G <sup>1</sup> / <sub>4</sub>	18	M5	8	18,5	47	17	10
204812	12	G <sup>3</sup> / <sub>8</sub>	21	G <sup>1</sup> / <sub>8</sub>	9	21	53,5	20	10

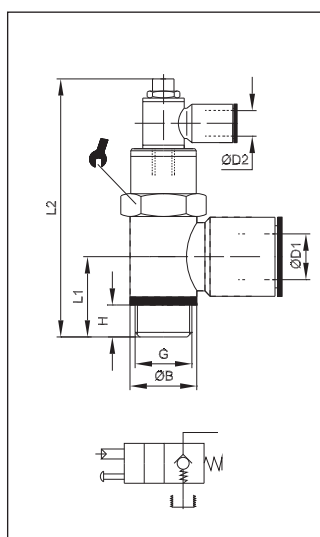

## vtso 049

### Obojstranný škrtiaci ventil

Bidirectional flow regulator

VT	ØD1	G	ØB	ØD2	H	L1	L2		
204902	4	G <sup>1</sup> / <sub>8</sub>	14	4	6	15,5	62	13	10
204905	6	G <sup>1</sup> / <sub>8</sub>	14	4	6	15,5	62	13	10
204906	6	G <sup>1</sup> / <sub>4</sub>	18	4	8	18,5	67	17	10
204907	8	G <sup>1</sup> / <sub>8</sub>	14	4	6	15,5	62	13	10
204908	8	G <sup>1</sup> / <sub>4</sub>	18	4	8	18,5	67	17	10
204909	8	G <sup>3</sup> / <sub>8</sub>	21	6	9	21	76,5	20	10
204910	10	G <sup>1</sup> / <sub>4</sub>	18	4	8	18,5	67	17	10
204911	10	G <sup>3</sup> / <sub>8</sub>	21	6	9	21	76,5	20	10
204914	12	G <sup>1</sup> / <sub>4</sub>	18	4	8	18,5	67	17	10
204912	12	G <sup>3</sup> / <sub>8</sub>	21	6	9	21	76,5	20	10

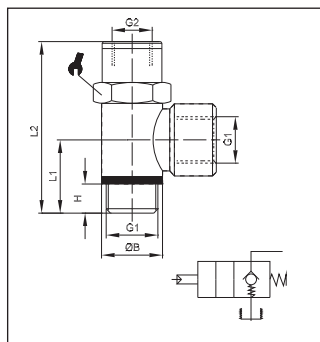

### Obojstranný škrtiaci ventil

Bidirectional flow regulator

VT	G1	ØB	G2	H	L1	L2		
304622	G <sup>1</sup> / <sub>8</sub>	15	M5	6	15,5	42	13	10
304623	G <sup>1</sup> / <sub>4</sub>	18	M5	8	18,5	47	17	10
304624	G <sup>3</sup> / <sub>8</sub>	22	G <sup>1</sup> / <sub>8</sub>	9	21	53,5	20	10
304625	G <sup>1</sup> / <sub>2</sub>	27	G <sup>1</sup> / <sub>8</sub>	10	24,5	60	25	10

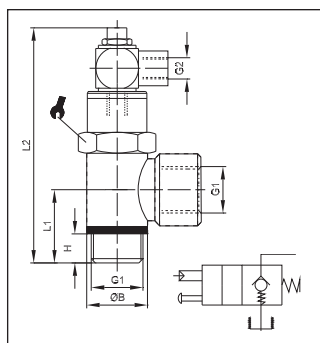

### Obojstranný škrtiaci ventil

Bidirectional flow regulator

VT	G1	ØB	G2	H	L1	L2		
304612	G <sup>1</sup> / <sub>8</sub>	15	M5	6	15,5	62	13	10
304613	G <sup>1</sup> / <sub>4</sub>	18	M5	8	18,5	67	17	10
304614	G <sup>3</sup> / <sub>8</sub>	22	G <sup>1</sup> / <sub>8</sub>	9	21	76,5	20	10
304615	G <sup>1</sup> / <sub>2</sub>	27	G <sup>1</sup> / <sub>8</sub>	10	24,5	83	25	10

G	Durchfluss in NI/min. bei 6 bar	Steuerdruck in Abhängigkeit zum Arbeitsdruck				
		1,5	2	3	3,5	4
G <sup>1</sup> / <sub>8</sub>	400	1,5	2	3	3,5	4
G <sup>1</sup> / <sub>4</sub>	850	1,5	2	3	3,5	4
G <sup>3</sup> / <sub>8</sub>	1250	1,5	2	3	3,5	4
G <sup>1</sup> / <sub>2</sub>	1800	1,5	2	3	3,5	4
		2bar	4bar	6bar	8bar	10bar

fluid division  
VT-HADICE & PLAST

Pracovný tlak: 2bar a ž 10bar  
Pracovná teplota: -5°C až +70°C