

STX – Nástrčné šrubenia z nerezovej ocele

STX – Push-in fittings stainless steel



Funkcie

- ▶ **Koncovky zo 100% nerez 1.4401**
 - ▶ **Montáž na jeden pohyb**
 - ▶ **Pre trúbky z rôznych materiálov (PU, PA)**
 - ▶ **Malé rozmery a nízka hmotnosť**
 - ▶ **FKM O-krúžky pre vysoké teploty**
 - ▶ **Štandardné, flexibilné štruktúry**
- ▶ **Fitting 100% stainless steel 1.4401**
 - ▶ **Tube assembly with one movement**
 - ▶ **For tubes in various materials (PU, PA)**
 - ▶ **Small-scale and low weight**
 - ▶ **FKM O-rings for high temperatures**
 - ▶ **Modular, flexible structure**

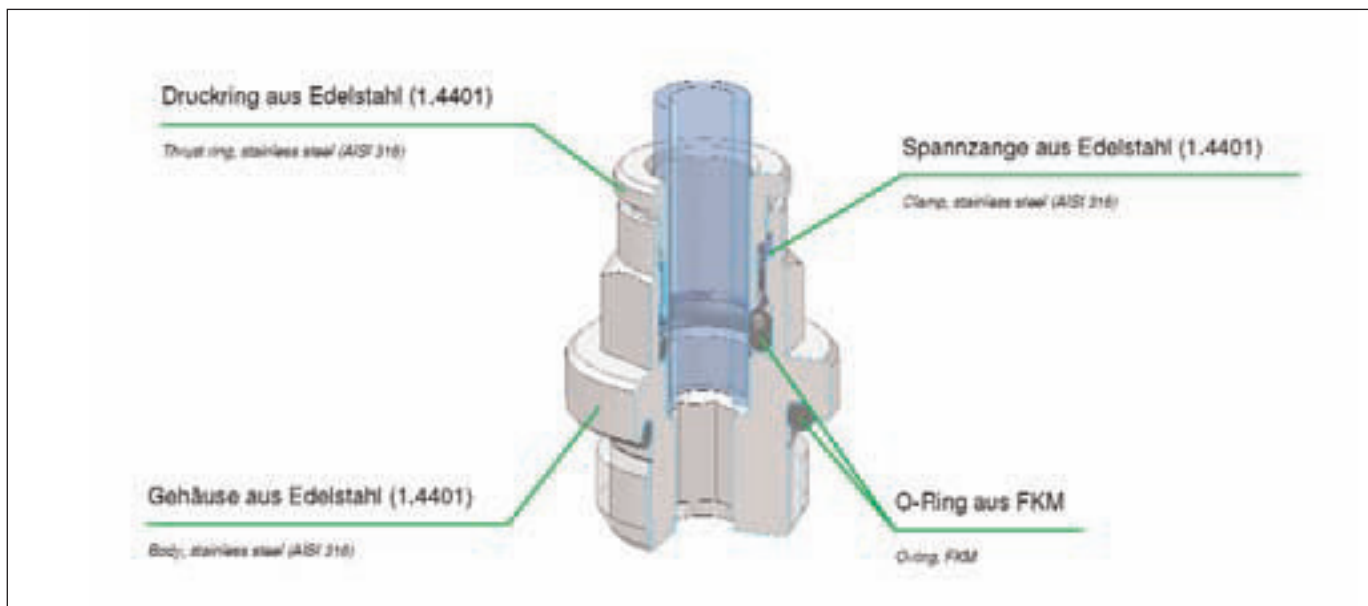

Technické údaje Technical data

Pracovná teplota Pracovný tlak	-20°C až +150°C až 16bar	Závisí od tlakového rozsahu použitej trúbky
Vákuum Materiály	max 98% Teleso z nerezovej ocele AISI 316 (1.4401) Tesnenie FKM Nerezová objímka AISI 316 (1.4401) Nerezový poistný krúžok AISI 316L Valcový závit DIN EN ISO 228 Kužeľový závit DIN EN 10226 (DIN 2999) Metrický závit DIN ISO 261	
Závit		Valcový s O krúžkom
Médium	Mazací a nemazací stlačený vzduch	Médium, ktoré je kompatibilné s materiálmi komponentov Odporúčané materiály: PU, PA
Hadica	Pre trubky podľa normy ISO 14743 Tolerancia pre vonkaj šie-Ø 4 až 8: ± 0,1 Tolerancia pre vonkaj šie-Ø 10 až 14: ± 0,15 (PU) 10 až 14: ± 0,1 (PA)	
Operating temperature Operating pressure	-20°C to +150°C Up to 16 bar	Dependent on the pressure range of the tube used
Vacuum Materials	max 98% Stainless steel housing, AISI 316 (1.4401) FKM seals Stainless steel clamp, AISI 316 (1.4401) Stainless steel thrust ring, AISI 316L (1.4404)	
Thread	Cyl. thread, DIN EN ISO 228 Con. thread, DIN EN 10226 (DIN 2999) Metr. thread, DIN ISO 261	Cylindrical with O-ring seal
Medium	Lubricated and non-lubricated compressed air	Mediums which are compatible with the component materials
Tubes	For tubes in line with ISO 14743 Tolerances for external Ø 4 to 8: ±0.1 Tolerances for external Ø 10 to 14: ±0.15 (PU) 10 to 14: ±0.1 (PA)	Recommended materials: PU, PA

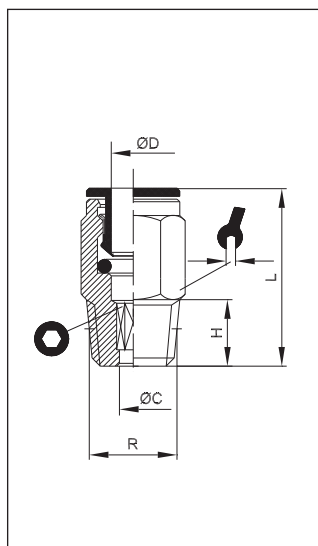

STX 11

Priama spojka s kuželovým závitom

Straight male adaptor con.

VT	ØD	R	ØB	ØC	H	L	□	⌘	■
110418	4	R ¹ / ₈	9	3	6,5	19	3	10	50
110414	4	R ¹ / ₄	9	3,4	11	20	3	14	50
110618	6	R ¹ / ₈	11	5	7,5	21	5	12	50
110614	6	R ¹ / ₄	11	5	11	21	5	14	50
110818	8	R ¹ / ₈	13	6	7,5	26	6	14	50
110814	8	R ¹ / ₄	13	6	11	23	6	14	50
111014	10	R ¹ / ₄	15	8,3	11	31	8	16	50
111038	10	R ³ / ₈	15	8,3	11,5	27	8	17	50
111238	12	R ³ / ₈	18	10,4	11,5	27	10	18	50
111212	12	R ¹ / ₂	18	10,4	14	27	10	22	50

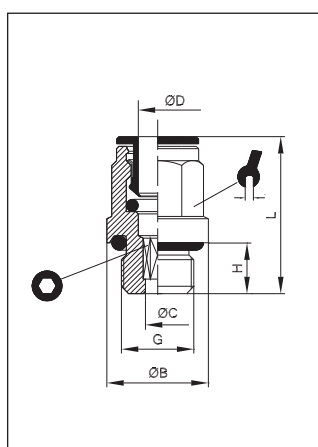

STX 12

Priama spojka so závitom

Straight male adaptor (parallel)

VT	ØD	G	ØB	ØC	H	L	□	⌘	■
120405	4	M5	8	2,5	4	20	-	9	10
120418	4	G ¹ / ₈	13	2,6	6	20	3	9	10
120618	6	G ¹ / ₈	13	4,2	6	24	4	13	10
120614	6	G ¹ / ₄	16	4,2	8	21,5	4	16	10
120818	8	G ¹ / ₈	13	5,2	6	26,5	5	13	10
120814	8	G ¹ / ₄	16	6,2	8	25	6	16	10

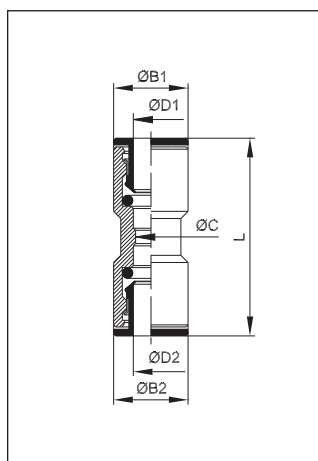

STX 26

Priama spojka

Straight connector

VT	ØD1	ØD2	ØB1	ØB2	ØC	L	■
260404	4	4	9	9	3	32	10
260606	6	6	11	11	5	33	10
260808	8	8	13	13	7	39	10
261010	10	10	15	15	9	39	10
261212	12	12	18	18	11	38	10

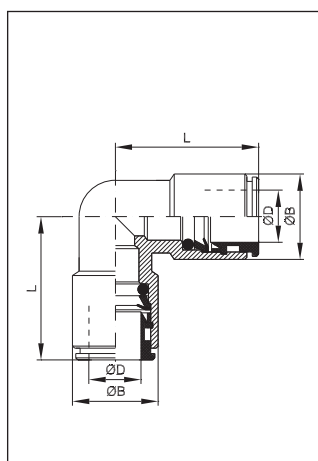

STX 28

L- spojka

Elbow connector

fluid division
VT-HADICE & PLAST

VT	ØD	ØB	L	■
280404	4	9	17	10
280606	6	12	20	10
280808	8	14	21	10
281010	10	16	25	10
281212	12	19	27	10

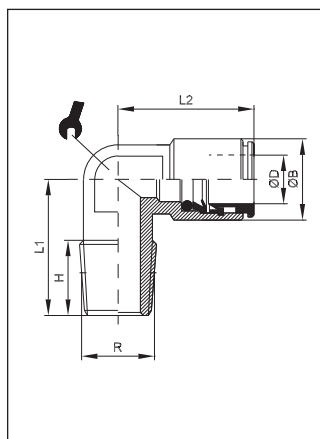

STX 14

L - spojka s kuželovitým závitem

Elbow taper male adaptor con.

VT	ØD	R	ØB	H	L1	L2		
140418	4	R ^{1/8}	9	7,5	16	17	9	10
140618	6	R ^{1/8}	12	7,5	16	20	9	10
140614	6	R ^{1/4}	12	11	20	20	11	10
140818	8	R ^{1/8}	14	7,5	17	21	11	10
140814	8	R ^{1/4}	14	11	20	21	11	10

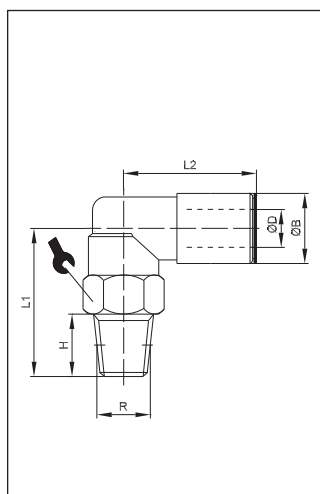

STX 15

Otočná L - spojka s kuželovitým závitem

Swivel elbow adaptor

VT	ØD	R	ØB	H	L1	L2		
150418	4	R ^{1/8}	9	7	20	20	10	10
150618	6	R ^{1/8}	11	7	20	21	13	10
150614	6	R ^{1/4}	11	11	25	21	14	10
150818	8	R ^{1/8}	13	7	20	24	13	10
150814	8	R ^{1/4}	13	11	25	24	14	10
151014	10	R ^{1/4}	16	11	26,5	25,5	16	10
151038	10	R ^{3/8}	16	11,5	27	25,5	17	10
151238	12	R ^{3/8}	19	11,5	30,5	28	20	10
151212	12	R ^{1/2}	19	14	33,5	28	22	10

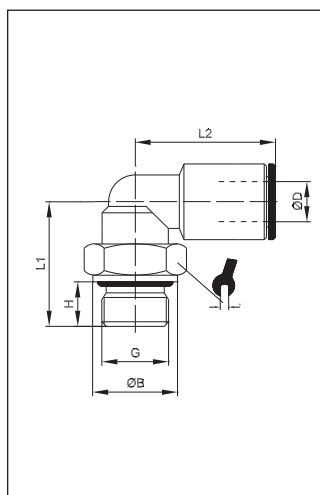

STX 16

Otočná L - spojka so závitem

Swivel elbow parallel adaptor

VT	ØD	G	ØB	H	L1	L2		
160405	4	M5	8	4	14,5	17	9	10
160418	4	G ^{1/8}	13	5,5	19,5	20	13	10
160618	6	G ^{1/8}	13	5,5	19,5	21	13	10
160614	6	G ^{1/4}	16	6,5	20,5	21	16	10
160818	8	G ^{1/8}	13	5,5	19,5	24	13	10
160814	8	G ^{1/4}	16	6,5	20,5	24	16	10

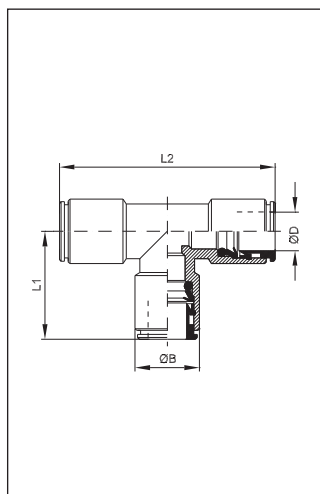

STX 29

T-spojka

T-connector

fluid division
VT-HADICE & PLAST

VT	ØD	ØB	L1	L2	
290404	4	9,0	17,0	34,0	10
290606	6	12,0	20,0	40,0	10
290808	8	14,0	21,0	42,0	10
291010	10	16,0	25,0	50,0	10
291212	12	19,0	27,0	54,0	10

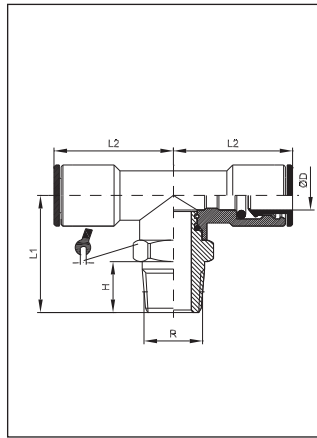

STX 20

Otočná T - spojka s kuželovým závitom

Swivel t-adaptor con.

VT	ØD	R	ØB	H	L1	L2		
200418	4	R ^{1/8}	9	7,5	21,5	17	10	10
206018	6	R ^{1/8}	12	7,5	24,5	21	13	10
206014	6	R ^{1/4}	12	11	28,5	21	14	10
208018	8	R ^{1/8}	14	7	24,5	21,5	13	10
208014	8	R ^{1/4}	13	11	25	23,5	14	10
201014	10	R ^{1/4}	16	11	32	24	16	10
201038	10	R ^{3/8}	16	11,5	32,5	24	18	10

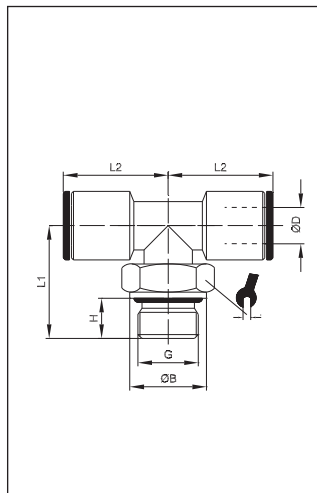

STX 21

Otočná T - spojka so závitom

Swivel t-adaptor, parallel

VT	ØD	G	ØB	H	L1	L2		
210405	4	M5	8	4	18	17	9	10
210418	4	G ^{1/8}	13	5	20	17	13	10
210618	6	G ^{1/8}	13	5,5	19,5	22	13	10
210614	6	G ^{1/4}	16	6,5	24,5	21	16	10
210818	8	G ^{1/8}	13	5,5	19,5	23,5	13	10
210814	8	G ^{1/4}	16	6,5	20,5	23,5	16	10

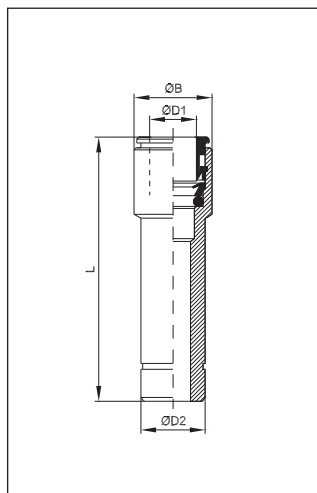

STX 25

Redukcia

Reducer

VT	ØD1	ØD2	ØB	L	
250406	4	6	9	31	10
250608	6	8	12	33	10
250810	8	10	14	34,5	10

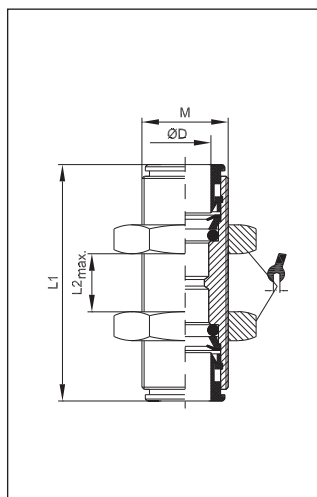

STX 27

Panelová spojka

Bulkhead union

fluid division
VT-HADICE & PLAST

VT	ØD	M	L1	L2 _{max}		
270404	4	M12x1	27	11	15	10
270606	6	M14x1	32,5	16	17	10
270808	8	M16x1	33	17	19	10
271010	10	M18x1	37,5	19	21	10
271212	12	M20x1	39,5	20	24	10

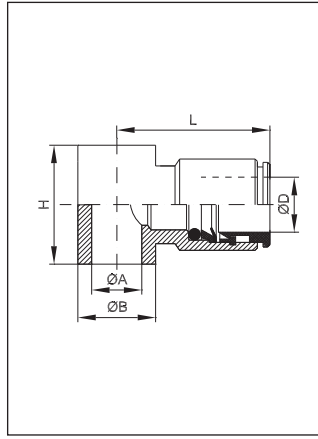

STX 35

Prietokové oko
Single banjo body

VT	ØD	ØA	ØB	H	L		
350418	4	G ^{1/8}	14	15	19,5		10
350618	6	G ^{1/8}	14	15	22		10
350614	6	G ^{1/4}	18	17	23,5		10
350818	8	G ^{1/8}	14	15	22,5		10
350814	8	G ^{1/4}	18	17	24		10

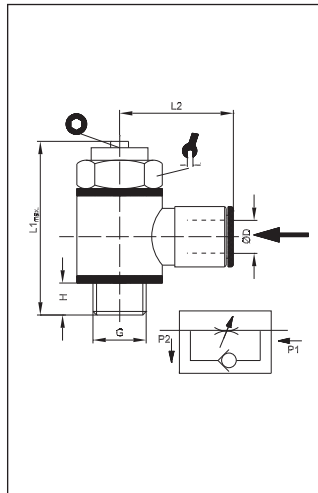

STX 40

Otočný škrtiaci ventil, regulácia s imbusovým kľúčom, typ A
Unidirectional flow regulator type A for valves

VT	ØD	G	H	L1max	L2			
400418	4	G ^{1/8}	5,5	36	19,5	14	2,5	10
400618	6	G ^{1/8}	5,5	36	22	14	2,5	10
400614	6	G ^{1/4}	6,5	42	23,5	17	3	10
400818	8	G ^{1/8}	5,5	36	22,5	14	2,5	10
400814	8	G ^{1/4}	6,5	42	24	17	3	10

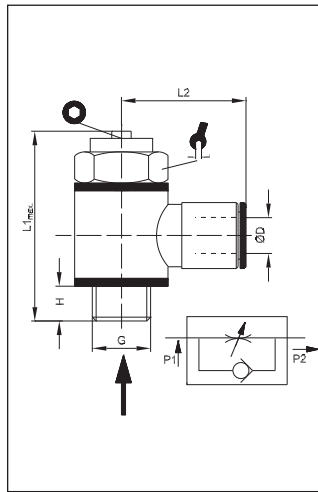

STX 41

Otočný škrtiaci ventil, regulácia s imbusovým kľúčom, typ B
Unidirectional flow regulator type B for cylinders

VT	ØD	G	H	L1max	L2			
410418	4	G ^{1/8}	5,5	36	19,5	14	2,5	10
410618	6	G ^{1/8}	5,5	36	22	14	2,5	10
410614	6	G ^{1/4}	6,5	42	23,5	17	3	10
410818	8	G ^{1/8}	5,5	36	22,5	14	2,5	10
410814	8	G ^{1/4}	6,5	42	24	17	3	10

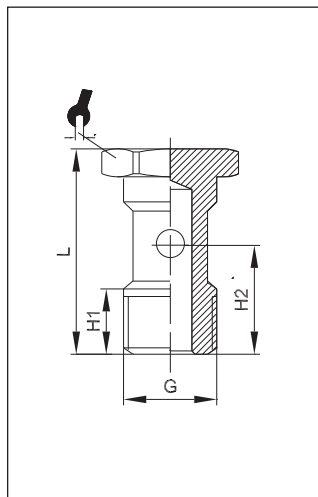

STX 31

Prietoková skrutka
Screw, incl. 2x Teflon-seals

VT	G	H1	H2	L		
310018	G ^{1/8}	8	15,5	29	14	50
310014	G ^{1/4}	9,5	17,5	32,5	17	50

fluid division
VT-HADICE & PLAST